

# Burleson Business Park - Building III 4101 Smith Road

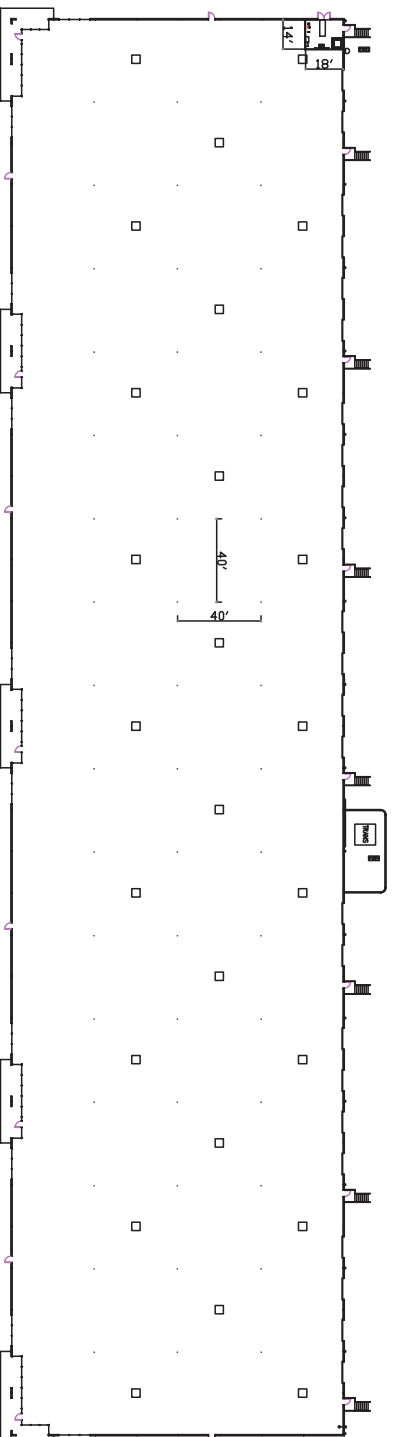

- 108,800 SF
- Class "A" Industrial
- Divisible to 6,400 SF
- Low-E Reflective Windows
- 24' Clear Height
- 40' x 40' Column Spacing
- 24 Dock-high Truck Doors
- 165' Shared Truck Court
- 277/480 Volt Electrical Service
- ESFR Sprinklered Space
- Skylights
- 2:1,000 SF Parking Ratio (Expandable to 4:1,000)
- Redundant Fiber Available
- Yard Space Available

For more information, contact:

TIG Real Estate Services  
TOM PARDEE  
901 S. Mo Pac Expressway  
Austin, TX 78746

512-901-0171  
tpardee@tigusa.com

